

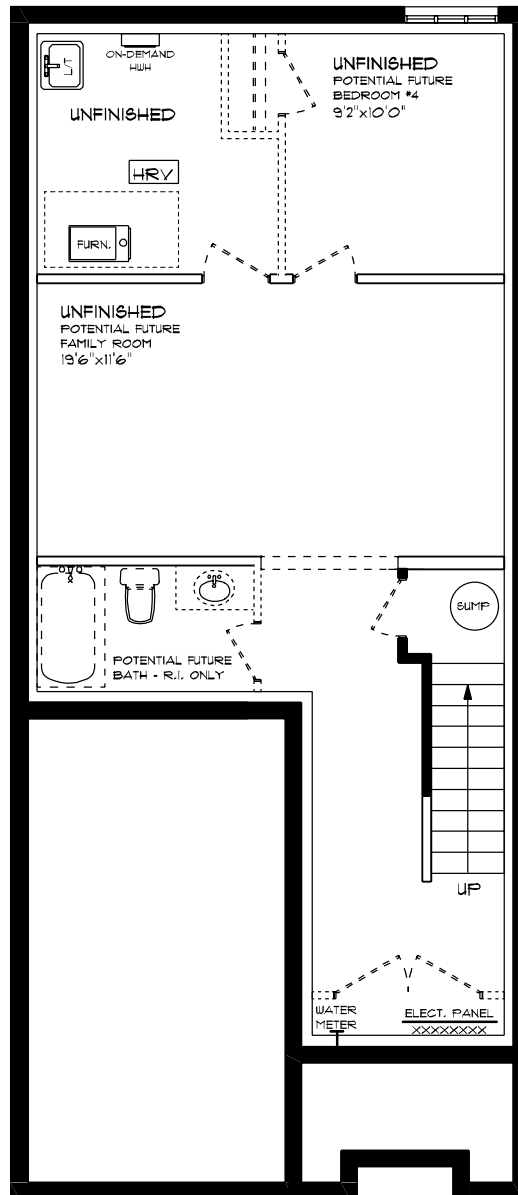

SHELTON (ESSENTIAL SPECS)
 LOT 45B (#12) WOODCOCK DRIVE
 FRONT ELEVATION
 8' MAIN FLOOR CEILING
 APPROX. 1,620 TOTAL SQ. FT.

This plan is the property of Hayhoe Homes and any reproduction of this plan, its concepts or ideas, is strictly prohibited. Plans and specifications are approximate and are subject to change without notice. Finished area and room dimensions will change depending on trim elevation selected on E40.E, 2023

CREATED JUN. 2023



**SHELTON (ESSENTIAL SPECS)
LOT 45B (#12) WOODCOCK DRIVE
LOWER LEVEL PLAN**

UNFINISHED

This plan is the property of Walpole Homes and any reproduction of this plan, its concepts or ideas, is strictly prohibited. Plans and specifications are approximate and are subject to change without notice. Finished area and room dimensions will change depending on front elevation selection. E.A.O.E. 2025

CREATED JUN. 2025

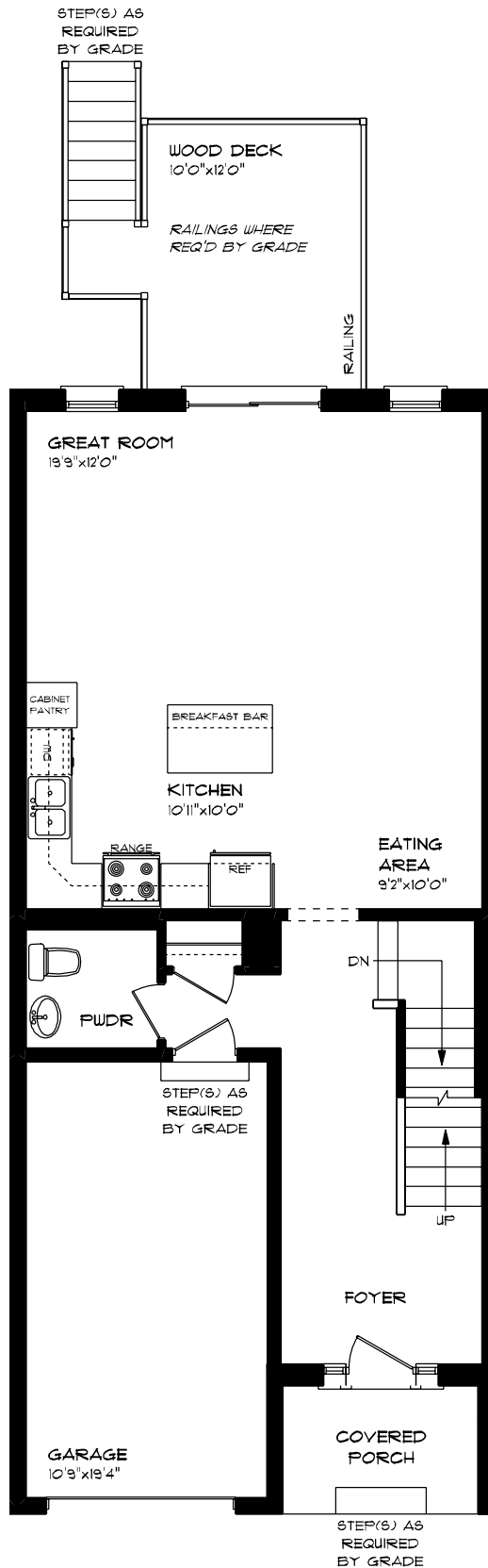

SHELTON (ESSENTIAL SPECS)
LOT 45B (#12) WOODCOCK DRIVE
MAIN FLOOR PLAN
8' MAIN FLOOR CEILING
APPROX. 166 SQ. FT.

This plan is the property of Hajjeh Homes and any reproduction of this plan, its concepts or ideas, is strictly prohibited. Plans and associations are approximate and are subject to change without notice. Finished area and room dimensions will change depending on front elevation selection. E.A.O.E. 1025

CREATED JUN. 2025

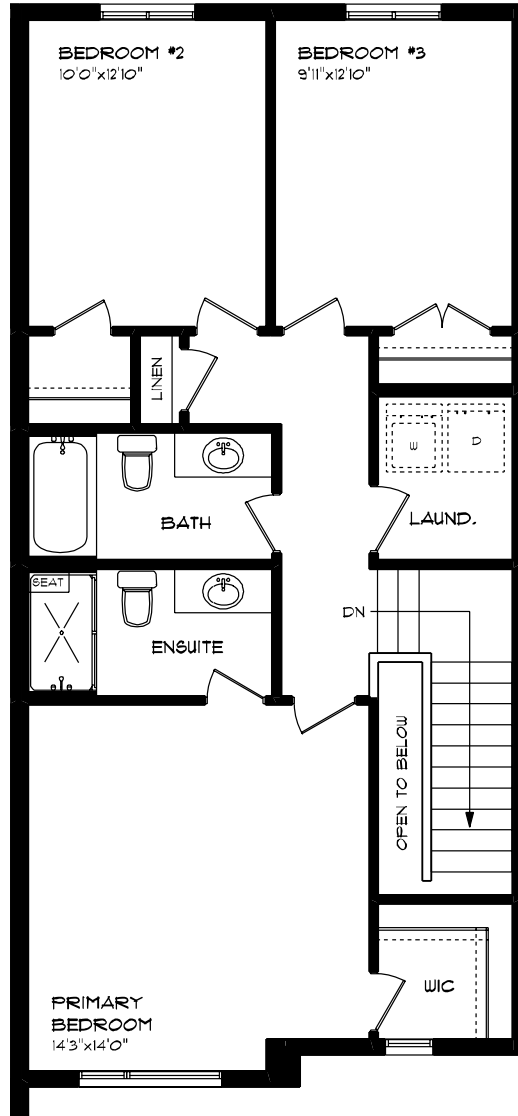

**SHELTON (ESSENTIAL SPECS)
LOT 45B (#12) WOODCOCK DRIVE
SECOND FLOOR PLAN**

APPROX. 854 SQ. FT.

This plan is the property of Hajos Homes and any reproduction of this plan, its concepts or ideas, is strictly prohibited. Plans and specifications are approximate and are subject to change without notice. Finished area and room dimensions will change depending on front elevation selection. E.A.O.E. 2025

CREATED JUN. 2025