

WILLOW RUN

89 WILLOW DRIVE

AYLMER | ONTARIO

TOWNHOME



THE DETAILS

PRICE	\$509,000
CLOSING DATE	Jun. 10, 2025
LOT NUMBER	4B
BEDROOMS	3
BATHS	2.5
GARAGE	1
DRIVEWAY	17'
SQ FT	1,842
MODEL	Townhome

Emma Smith SALES PROFESSIONAL

519.409.1474 | emma.smith@hayhoehomes.com



[WWW.HAYHOEHOMES.COM](http://www.hayhoehomes.com)

Price, products, colours & features are subject to change without notice. E. & O. E. DATE JANUARY 2025

HAYHOETM
— HOMES —

WILLOW RUN

SITE PLAN

89 WILLOW DRIVE | AYLMER ON

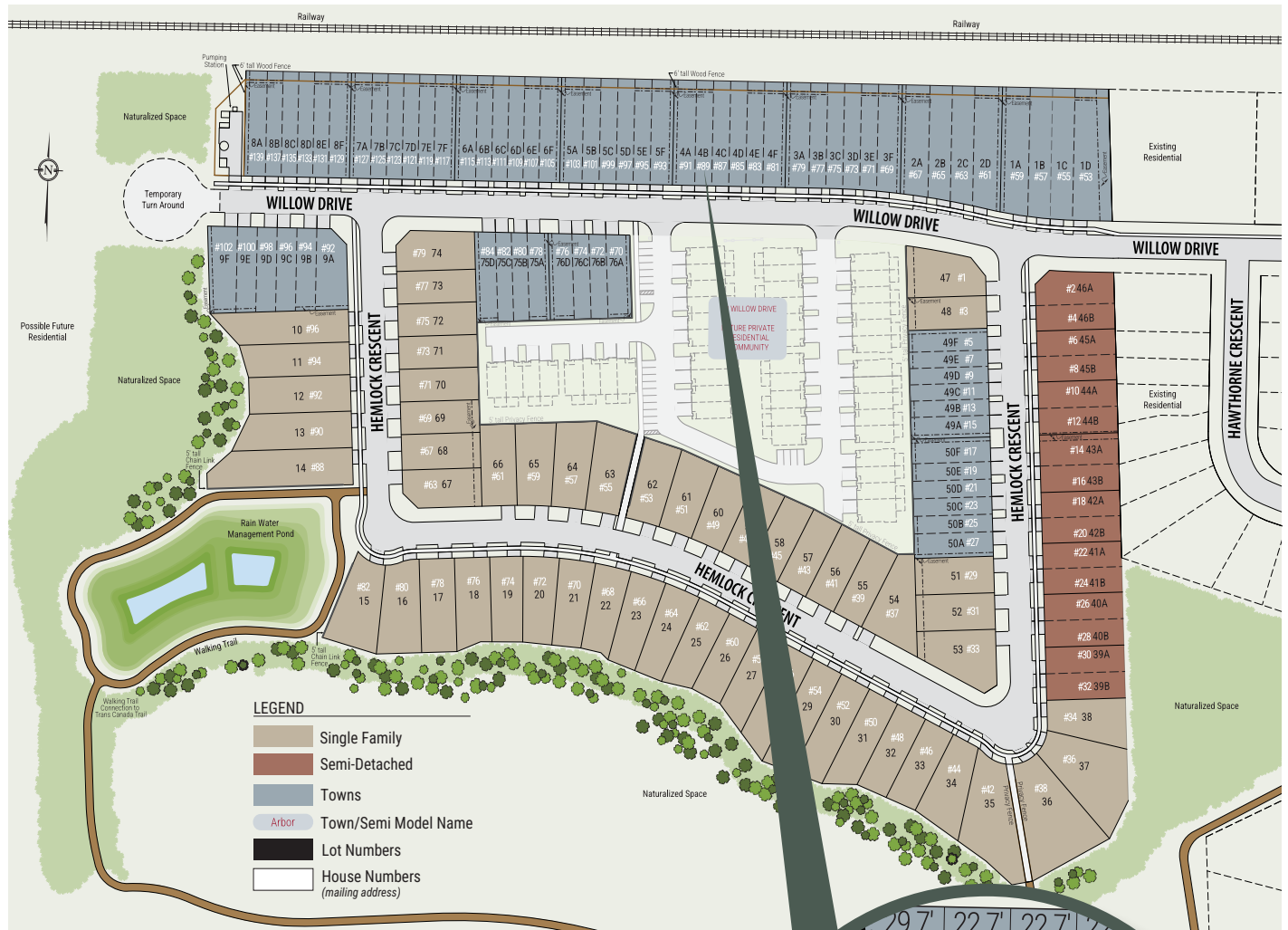

exterior features

KEYLESS ENTRY

TREATED WOOD DECK

ASPHALT DRIVEWAY

WALKING TRAILS

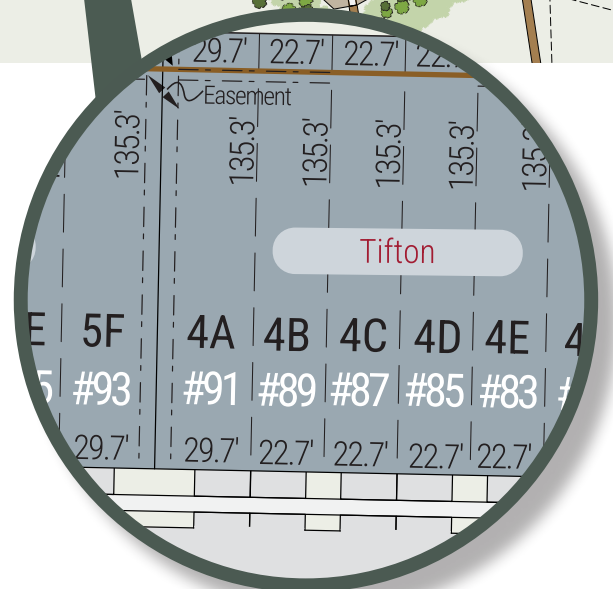

WILLOW RUN

89 WILLOW DRIVE

MAIN FLOOR

836 sq ft

features

VINYL PLANK FLOORING

QUARTZ COUNTERTOPS

KITCHEN ISLAND

9' CEILINGS

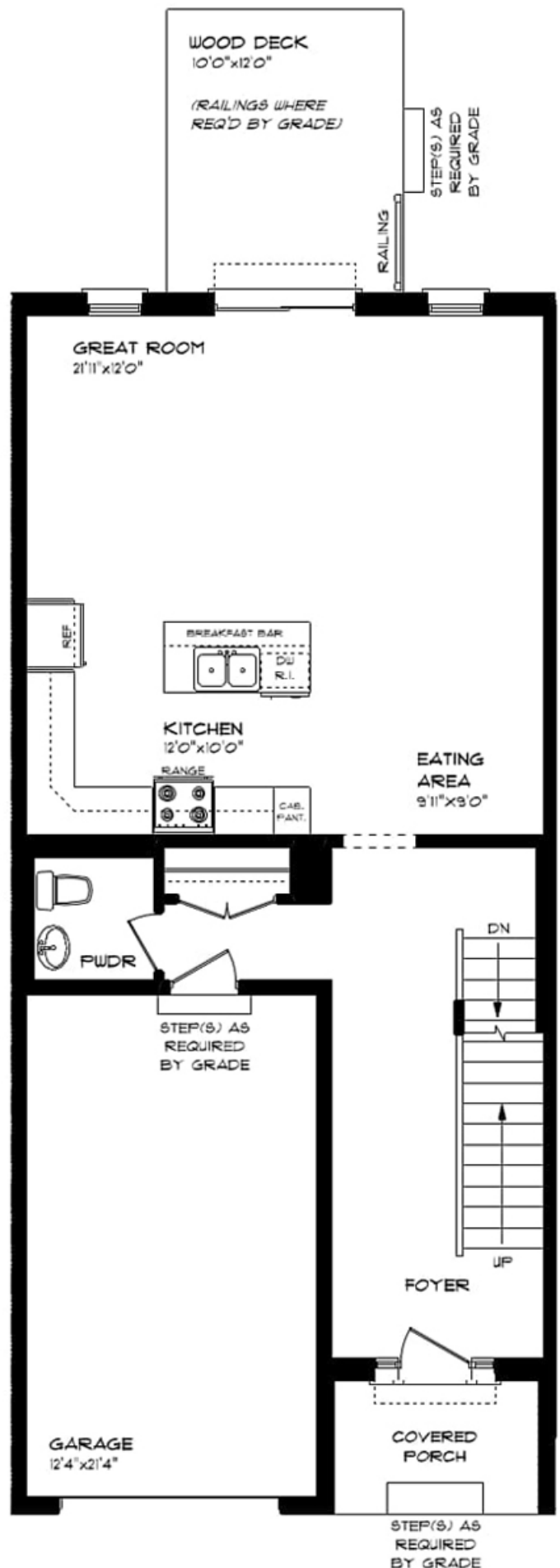

WILLOW RUN

89 WILLOW DRIVE

SECOND FLOOR

1,006 sq ft

features

PROFESSIONALLY DESIGNED

SOAKER TUB

CARPET FLOORING

VINYL PLANK FLOORING

WALK-IN CLOSET

DOUBLE ENSUITE VANITY

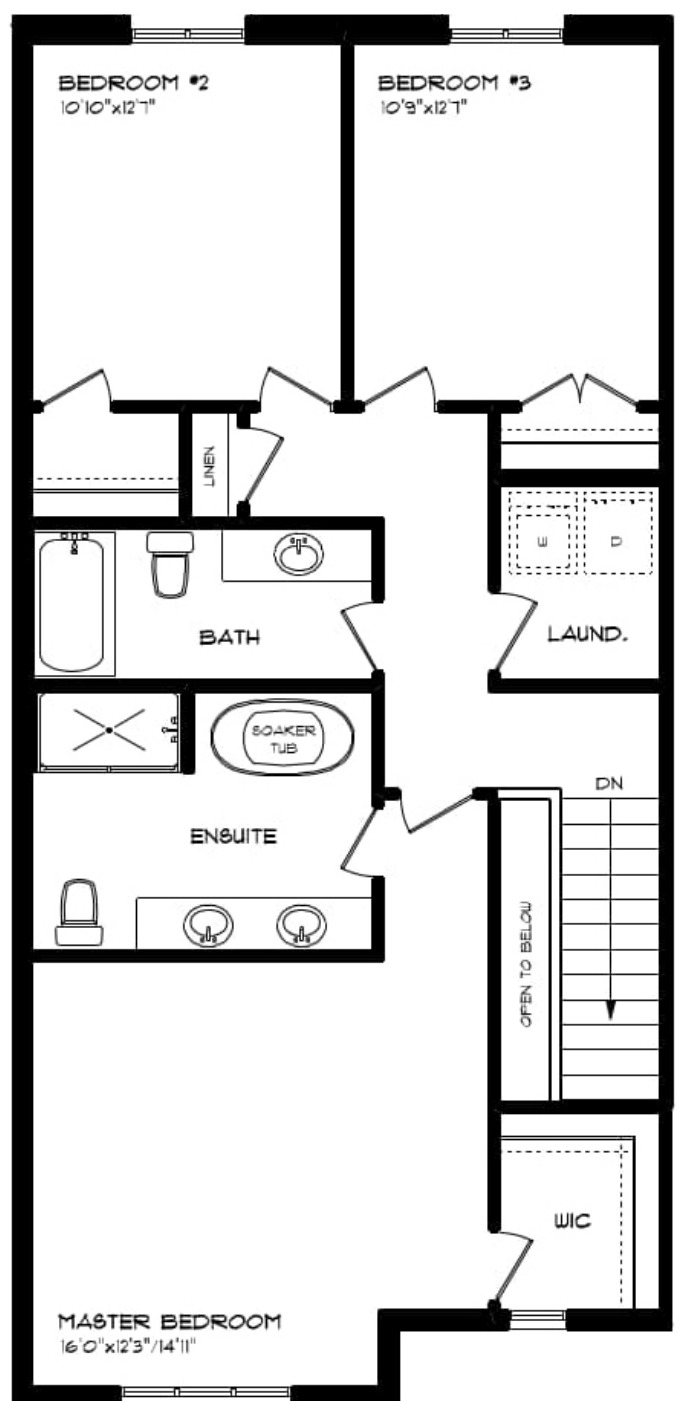

WILLOW RUN

89 WILLOW DRIVE

LOWER LEVEL UNFINISHED

features

AIR CONDITIONING

GAS FURNACE WITH HRV

HUMIDIFIER

NEW HOME WARRANTY

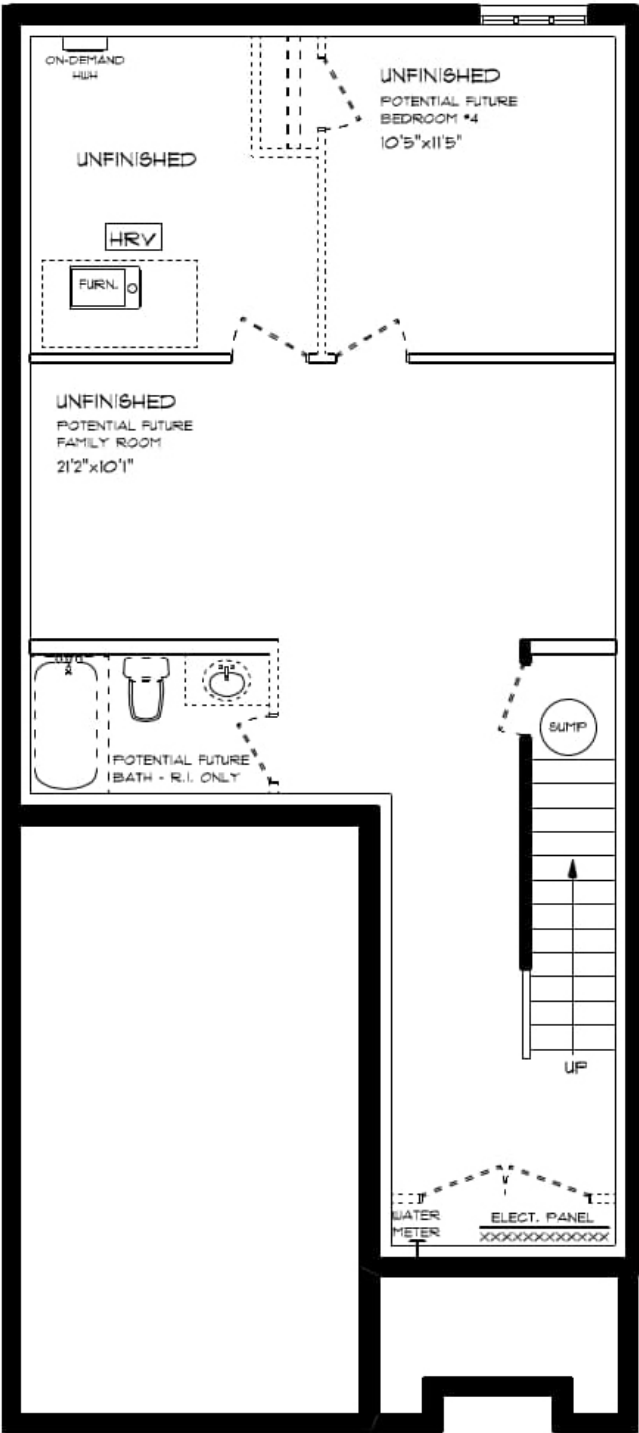

WILLOW RUN

89 WILLOW DRIVE

INTERIOR FINISHES



QUARTZ KITCHEN COUNTERTOPS



LUXURY VINYL PLANK

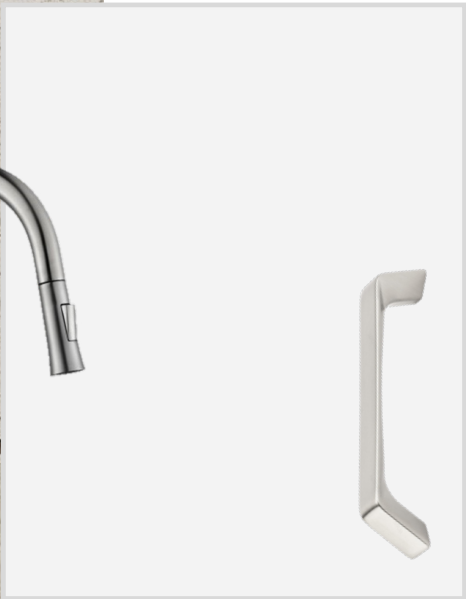
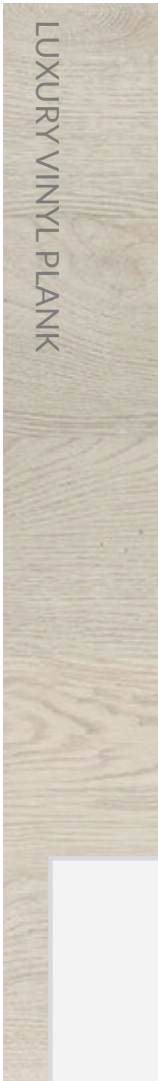

MELAMINE KITCHEN
CABINETRY

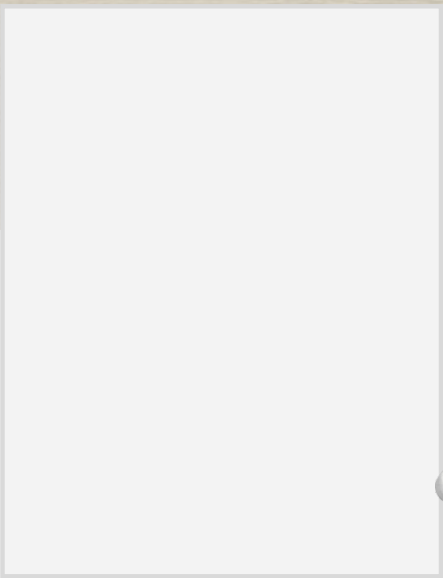

MELAMINE VANITY
CABINETRY



LAMINATE VANITY
COUNTERTOPS

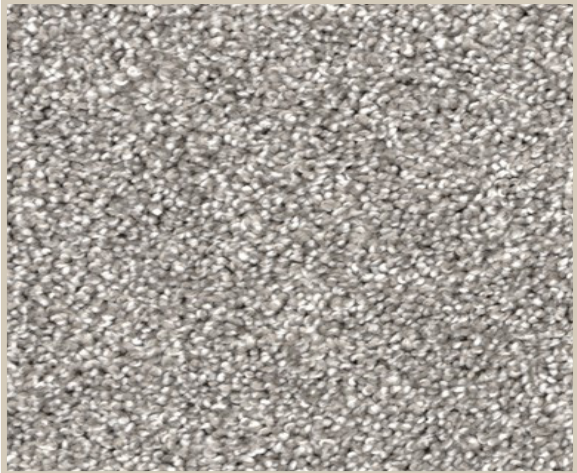

CARPET